

Positive stop

BES 08-FA-49
 Material: stainless steel
 Temperature range: -25...100 °C
 Spring force: 3 N
 Permissible tightening torque: 15 Nm

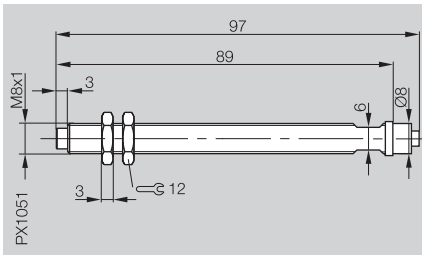

Positive stop

BES 08-FA-89
 Material: stainless steel
 Temperature range: -25...100 °C
 Spring force: 4 N
 Permissible tightening torque: 15 Nm

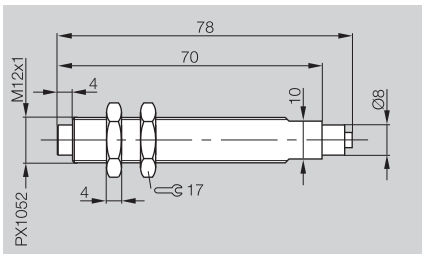

Positive stop

BES 12-FA-70
 Material: stainless steel
 Temperature range: -25...100 °C
 Spring force: 10 N
 Permissible tightening torque: 25 Nm

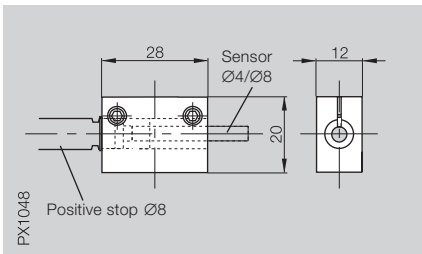

Positive stop

**mounting cuff straight
 for sensors with Ø 4 mm or Ø 8 mm**

BES 08-FA-BS-4,0-G
BES 08-FA-BS-8,0-G
 Material: Al
 Temperature range: -25...100 °C
 Permissible tightening torque: 15 Nm

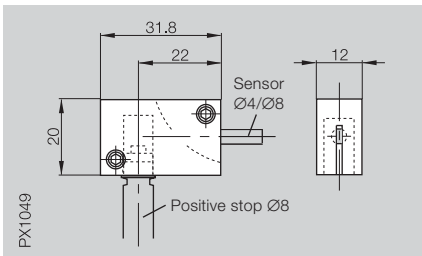

Positive stop

**mounting cuff right angle
 for sensors with Ø 4 mm or Ø 8 mm**

BES 08-FA-BS-4,0-W
BES 08-FA-BS-8,0-W
 Material: Al
 Temperature range: -25...100 °C
 Permissible tightening torque: 15 Nm

Positive stops for sensors with Ø 4 mm or Ø 8 mm housing

A positive stop combined with the corresponding mounting cuff is used to hold inductive proximity switching with housing diameters of Ø 4 mm or Ø 8 mm. The desired switching point between the proximity switch and the trigger pin can be set wherever needed.

