

Series	BMF 32	BMF 32	BMF 32
--------	--------	--------	--------

BMF 32 – the specialist for round cylinders as well as cylinders with trapezoidal slot. Also for universal use with many cylinder types using suitable mounting brackets.

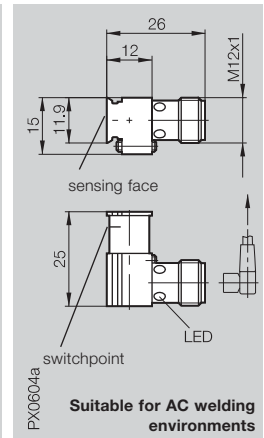
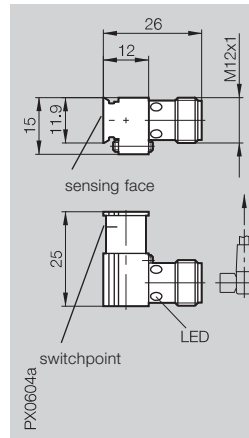
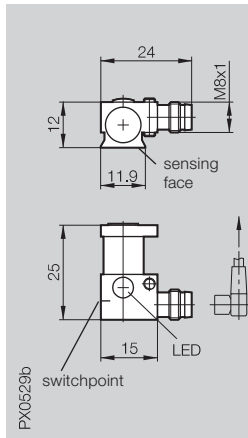
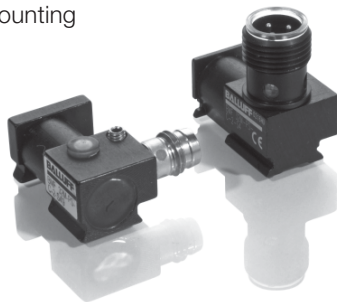

PNP	NO	BMF 32M-PS-C-2-S49	BMF 32M-PS-C-2-S4	BMF 32M-PS-W-2-S4
NPN	NO	BMF 32M-NS-C-2-S49	BMF 32M-NS-C-2-S4	
Rated operating field strength H _n		1.2 kA/m	1.2 kA/m	1.2 kA/m
Assured operating field strength H _a		≥ 2 kA/m	≥ 2 kA/m	≥ 2 kA/m
Hysteresis of H _n		≤ 45 %	≤ 45 %	≤ 45 %
Temperature drift of turn-on point of H _n		≤ 0.3 %/°C	≤ 0.3 %/°C	≤ 0.3 %/°C
Turn-on delay		≤ 0.05 ms	≤ 0.05 ms	≤ 0.05 ms
Turn-off delay		≤ 0.05 ms	≤ 0.05 ms	≤ 0.05 ms
Supply voltage U _B		10...30 V DC	10...30 V DC	10...30 V DC
Voltage drop U _d		≤ 3.1 V	≤ 3.1 V	≤ 4 V
Rated insulation voltage U _i		75 V DC	75 V DC	75 V DC
Rated operational current I _e		200 mA*	200 mA*	200 mA*
No-load supply current I ₀ max.		≤ 30 mA	≤ 30 mA	≤ 30 mA
Polarity reversal protected		yes	yes	yes
Short circuit protected		yes	yes	yes
Ambient temperature range T _a		-25...+85 °C	-25...+85 °C	-25...+85 °C
Utilization category		DC 13	DC 13	DC 13
Degree of protection per IEC 60529		IP 67	IP 67	IP 67
Housing material		Al	Al	Al
Connection		Connector	Connector	Connector
Approval		cULus	cULus	cULus
Recommended connector		BKS- 48/BKS- 49	BKS- 19/BKS- 20	BKS- 19/BKS- 20

*Temperature load curve see page 3.0.6

without mounting bracket



Cylinder with T-slot/
Trapezoidal slot

without mounting bracket for installation in cylinders with 60°- or 90°-trapezoidal slot e.g. Festo, Bosch, Martonair



Connector orientation

Wiring diagrams

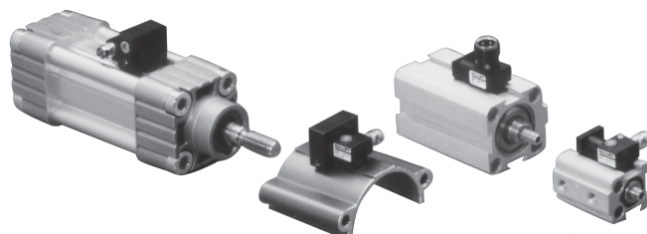
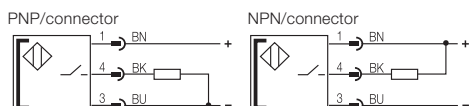

The series BMF 305M/315M/32M-...-W... is suitable for extreme conditions of use. The housings are metal, making them resistant to weld splatter. Conditions including weld currents of over 25 kA do not affect the function ability of the sensor. The output state of the sensor is stored during AC welding.



Hex Key Set



BMF Hex Key

Please order accessories separately see page 5.74

Sensors for Pneumatic Cylinders

Mounting brackets
for BMF 32

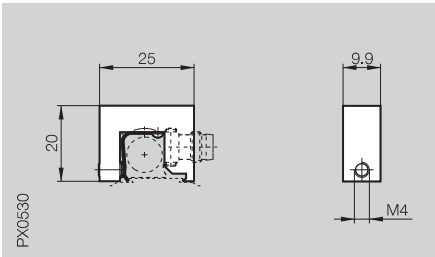

BMF 32-HW-12
for pneumatic cylinders with
trapezoidal rail (Bosch Rexroth)
any piston diameter

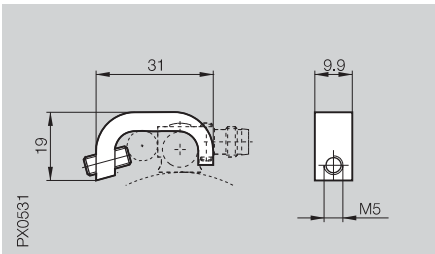
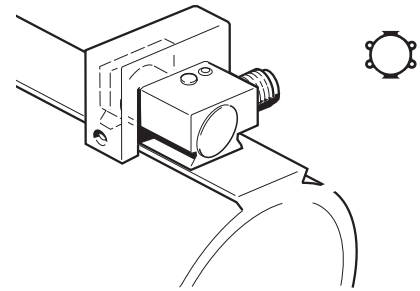

BMF 32-HW-13
for pneumatic cylinders with tie rod,
any piston diameter
tie rod diameter max. 11 mm

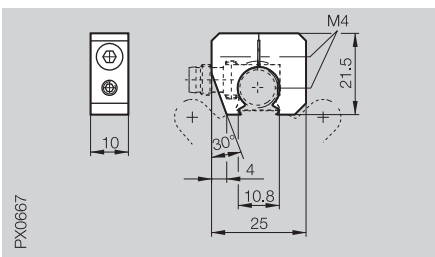
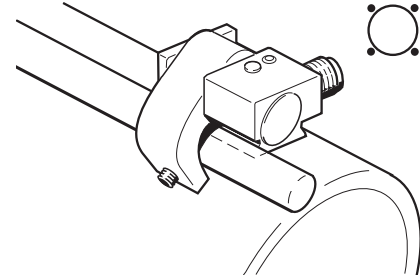

BMF 32-HW-14
for pneumatic cylinders with
trapezoidal rail (Bosch) Typ:
0 822 350/351/352/353/354/355
any piston diameter

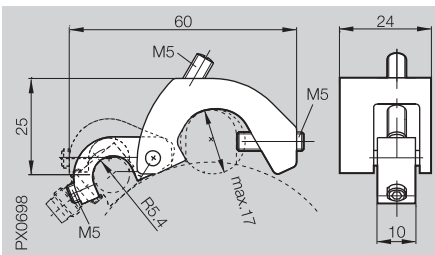
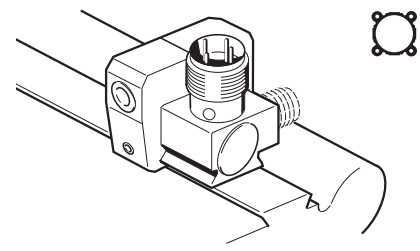

BMF 32-HW-15
for pneumatic cylinders with tie rod,
any piston diameter
tie rod diameter up to 17 mm
for pneumatic cylinders
with tie rod integrated in housing
any piston diameter
profile width up to 17 mm

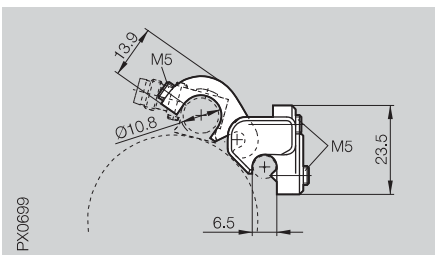
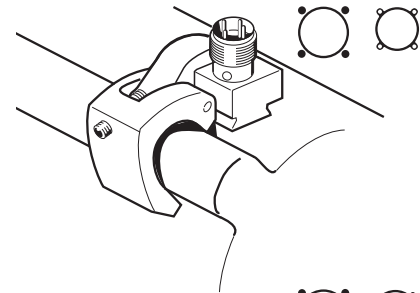

BMF 32-HW-16
for pneumatic cylinders with tie rod,
any piston diameter
tie rod diameter up to 6.5 mm

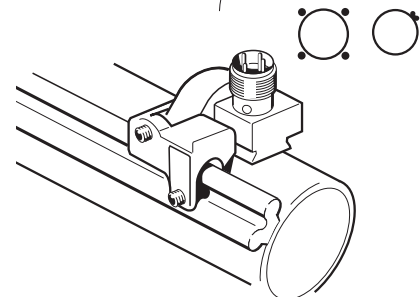

Pneumatic cylinders with DUO rail
(Festo), piston diameter any

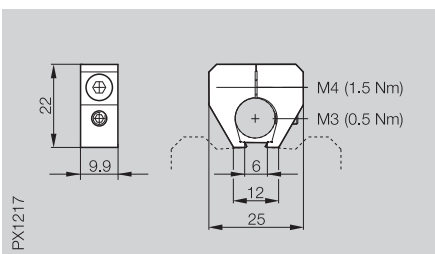

BMF 32-HW-18
for pneumatic cylinders with trapezoidal
rail Bosch Rexroth Series 2700

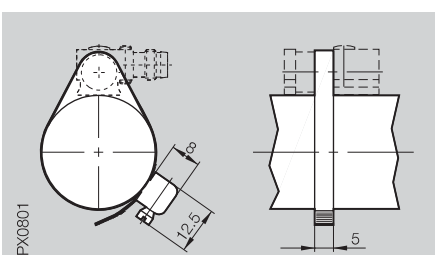
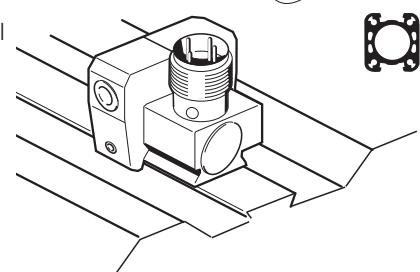

BMF hose clamp size 0...8
stainless steel for pneumatic cylinders
without tie rod/rail piston diameter up
to 80 mm



For hose clamp matrix
see page 3.0.10.

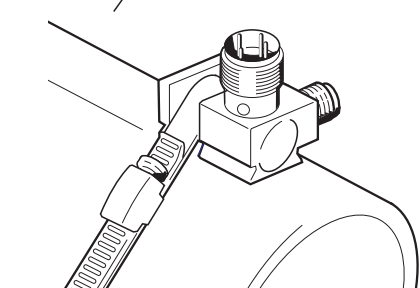

3.1

Connectors
selection
guide
page 3.0.7 ...

5

Connectors ...
page 5.2 ...